



TOWN OF RIDGWAY  
ATHLETIC PARK PAVILION  
CONCEPT DESIGN OPTIONS  
NOVEMBER 14, 2019

[WWW.RA-AE.COM](http://WWW.RA-AE.COM)

## DESIGN TEAM





SITE











## PROGRAM

# STAKEHOLDER INTERVIEWS

PROGRAM

Baseball

Soccer

Planning Commissioner

RAT Group

Dog Owners

Pickle-ball

Polo Estates Development

Planning Department

# STAKEHOLDER MEETING INTERVIEW QUESTIONS

## PROGRAM

### Current Park Use

How does your group currently use the park?

How often & what times does your group currently use the park?

### Pavilion Use

How do you envision your group using the Pavilion?

How often do you envision your group using the Pavilion?

### Pavilion Size

What size /type of storage does your group require?

How much sheltered seating does your group require?

What size / function of the concessions are is critical for your group?

### Features

Are there any other design features or considerations that would make the pavilion more functional for your group?

### Style

What building in town best captures the character of Ridgway?

What building in town best captures the history and future of Ridgway?

What materials or style do you envision for the pavilion?

### Location

What Pavilion location would be best for the use of your group?



# DESIGN OBJECTIVES

## PROGRAM

### Environment

- Design to be sensitive to prevailing winds
- Design to consider sun angles and optimizing shade
- Design should capture mountain views

### Context

- Design to be low in height so views are not obstructed
- Design to reference local materials and styles

### Location

- Locate in a way that takes advantage of existing utilities
- Locate to best serve the park functions
- Location to be sensitive to future park master planning

## SQUARE FOOTAGE REQUESTS

### PROGRAM

#### Storage

- 200 SF Soccer Storage
- 16 SF Pickle-ball (snowblower)
- 16 SF Dog Owner's Group (training / agility)
- ? SF Baseball
- 0 SF Public works
- 0 SF RAT group

#### Provided

200 SF  
25 SF  
25 SF  
25 SF

#### Concessions

- 2 Person concessions
- Concessions storage
- Service counter with roll up door
- 2 bay sink
- Counter-tops
- Power

100 SF  
25 SF

#### Shelter

- 40-200 people
- Power - lockable
- Covered Seating : Picnic Tables

1,900 SF (120 People)

#### Total

2,300 SF

## ADDITIONAL REQUESTS

### PROGRAM

- Bleachers
- Refrigerator
- Operable enclosure (glass, shades, curtains)
- Play structure
- Mural
- Kick wall
- Bottle Filler
- Dog water fountain
- Field lighting
- Restroom facade improvements
- Fireplace on timer
- Solar Panels
- Scoreboard
- WIFI
- Changing room – pickle ball
- Coaches office – soccer
- Locker room – soccer
- Ditch / drainage improvement



## LOCATION OPTIONS

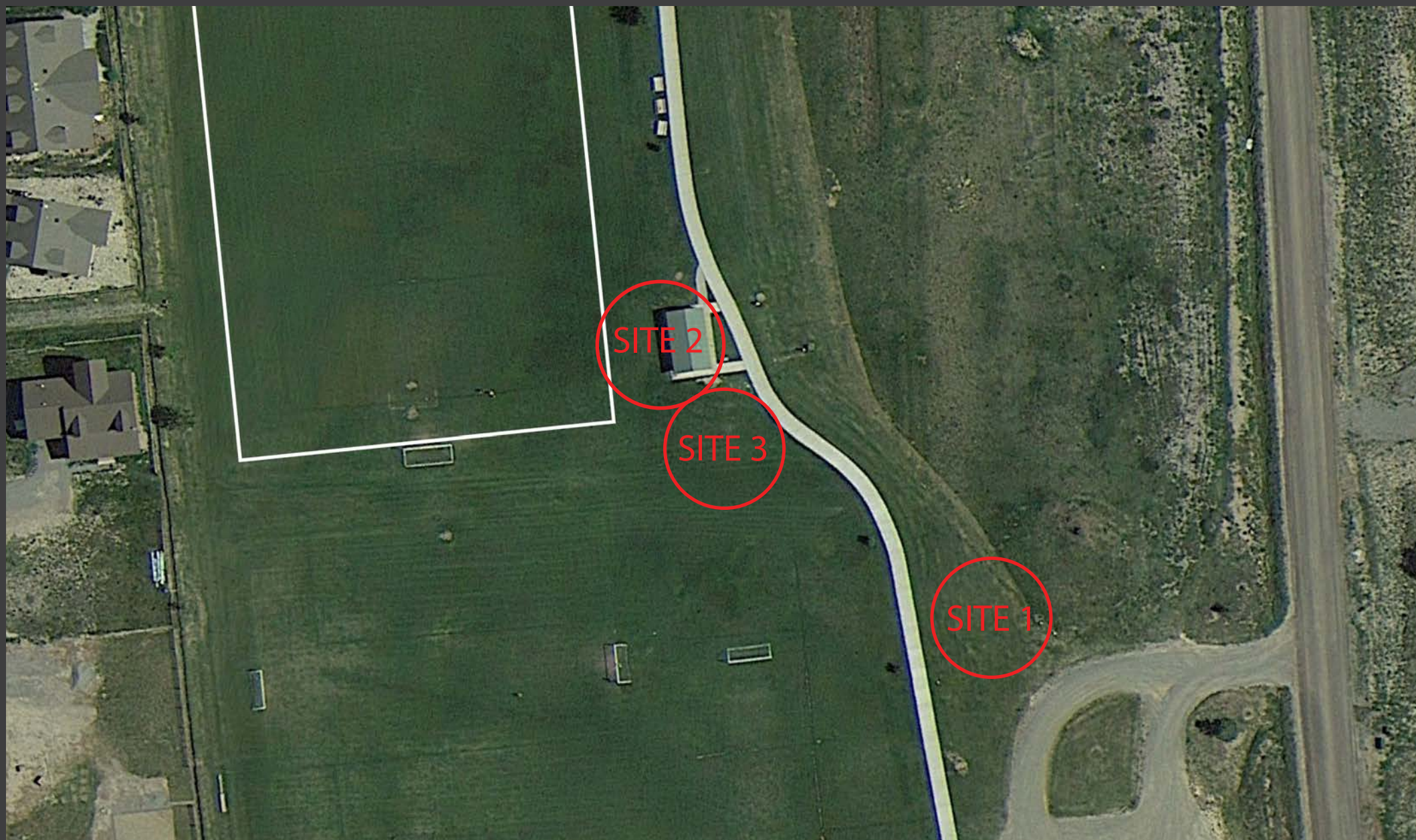



## SITE 1

### LOCATION OPTION

#### PROS

- Closest to the parking area
- Closer to future phases of the park
- Highly visible from the road
- Standalone location not impacted by restrooms

#### CONS

- Furthest from utilities
- Furthest from the restrooms
- Furthest from soccer fields





SITE 1

PLAN

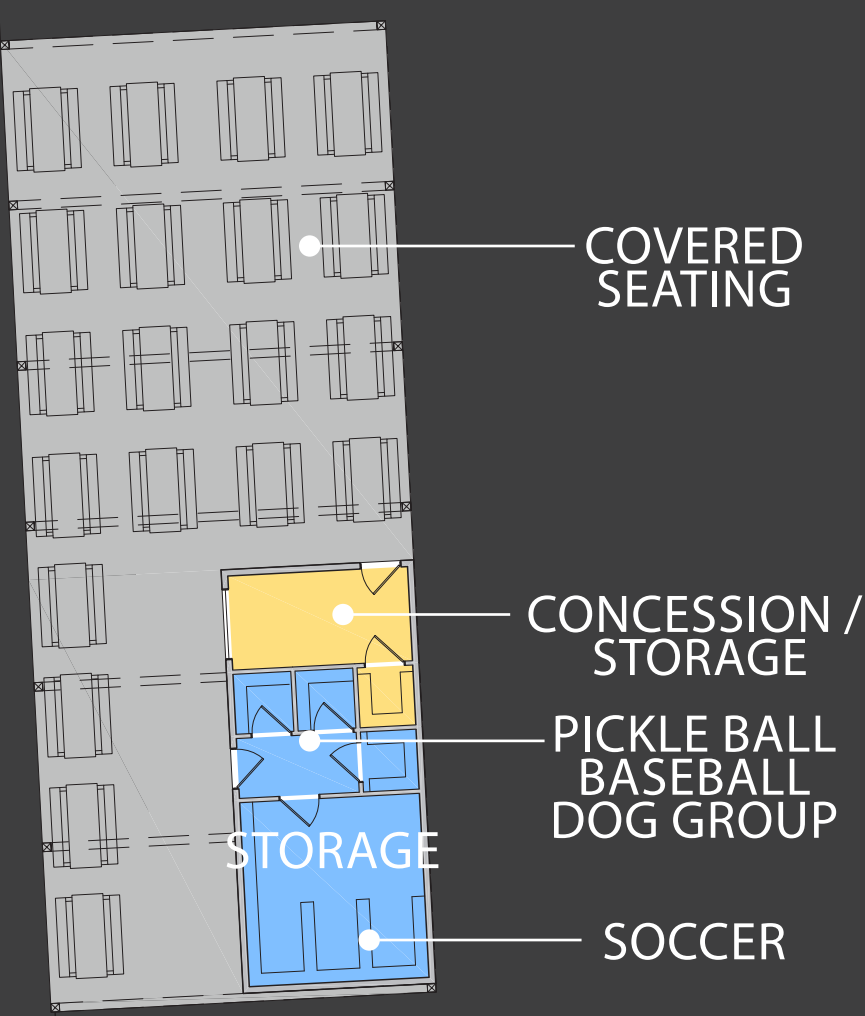

## SITE 1

RENDERING





## SITE 1

RENDERING

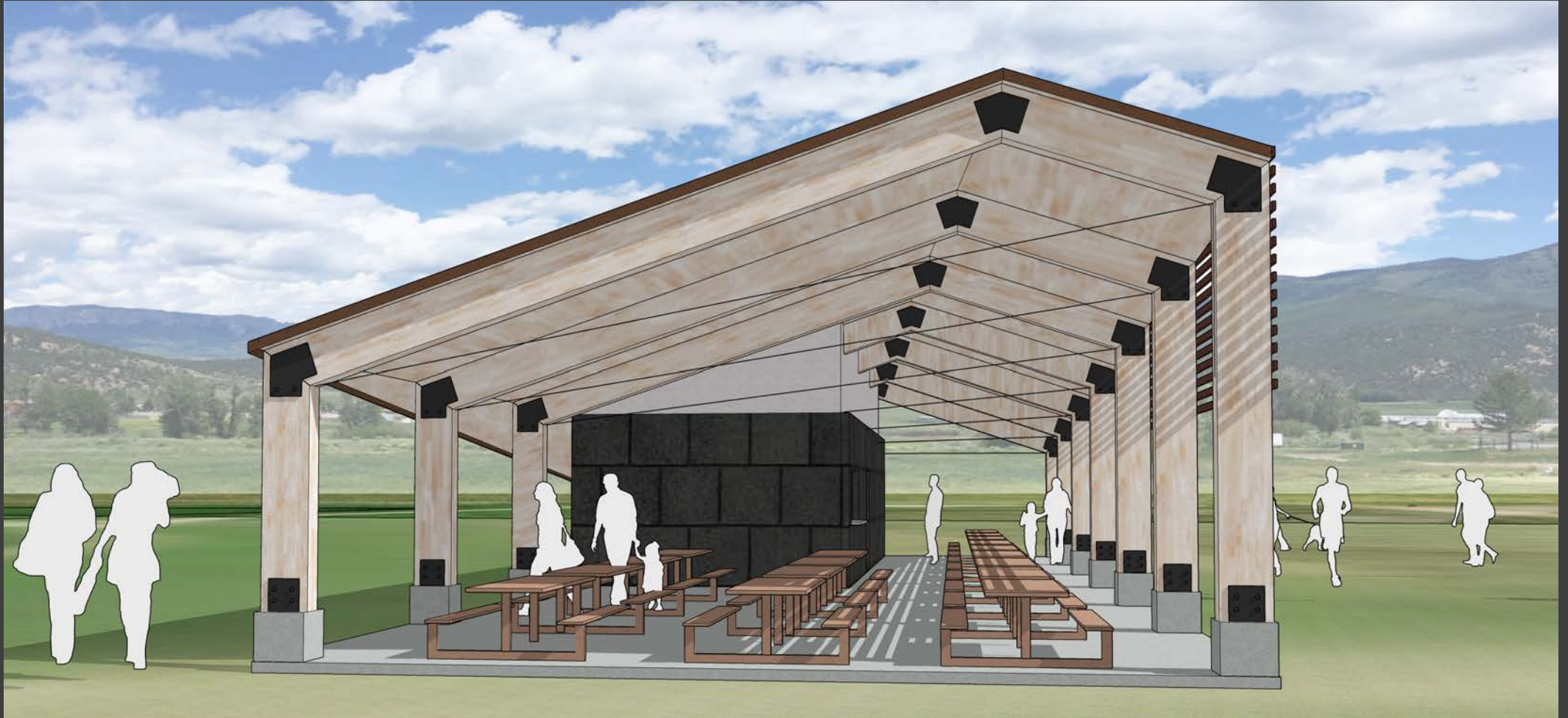



SITE 1

RENDERING



## SITE 2

### LOCATION OPTION

#### PROS

- Incorporates / disguises restrooms
- Consolidates resources
- Closest to utilities
- Closest to soccer fields

#### CONS

- Furthest from the parking area
- Least identifiable from road





SITE 2

PLAN

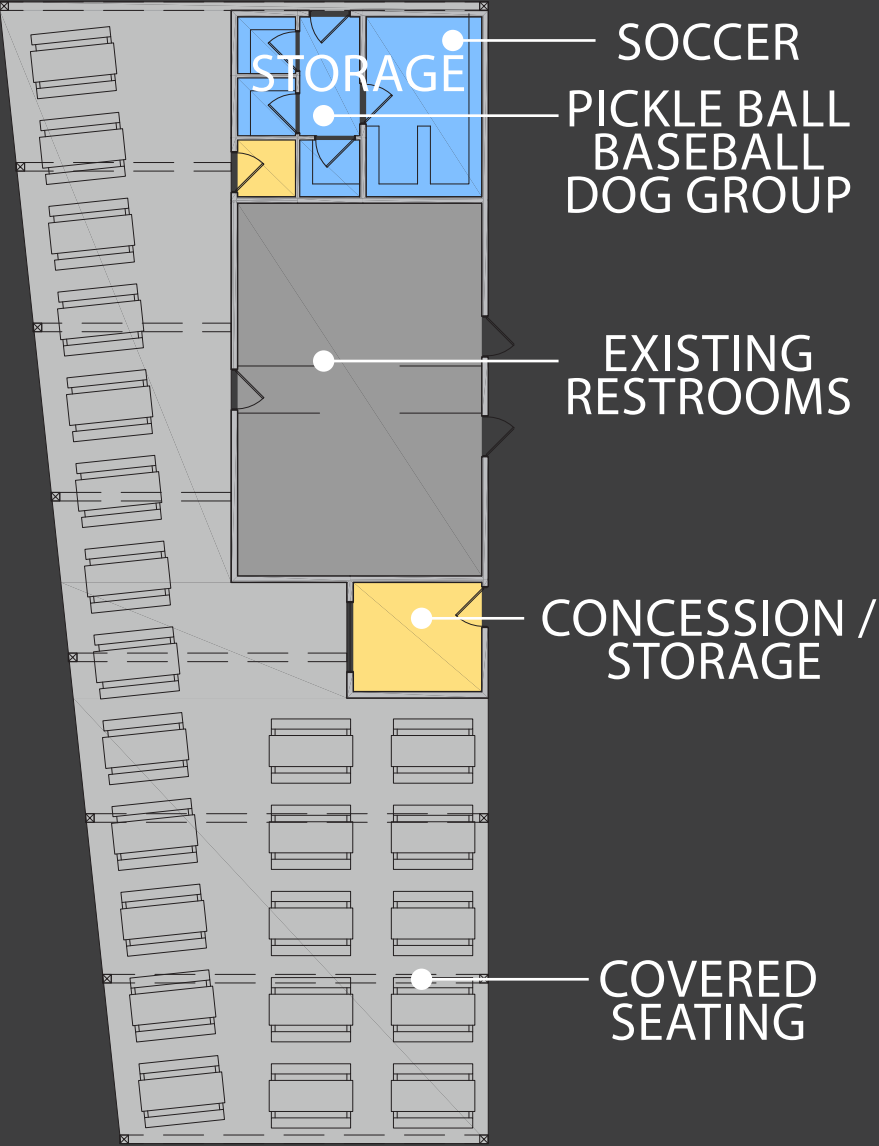

## SITE 2

RENDERING





## SITE 2

RENDERING



## SITE 2

RENDERING





## SITE 2

RENDERING



## SITE 3

LOCATION OPTION

### PROS

- Adjacent to restrooms
- Close to utilities
- Close to soccer fields

### CONS

- Furthest from the parking area





## SITE 3

PLAN

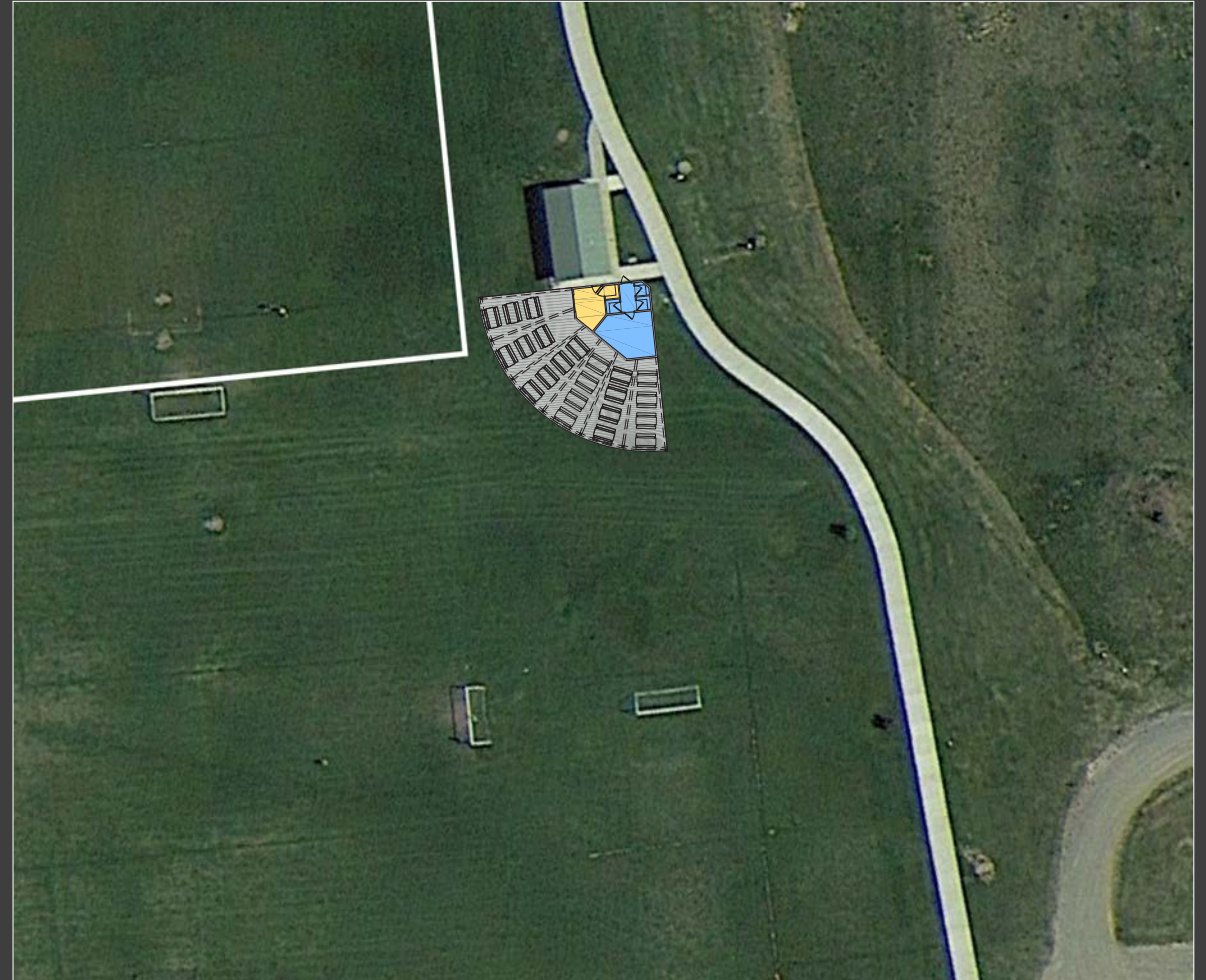
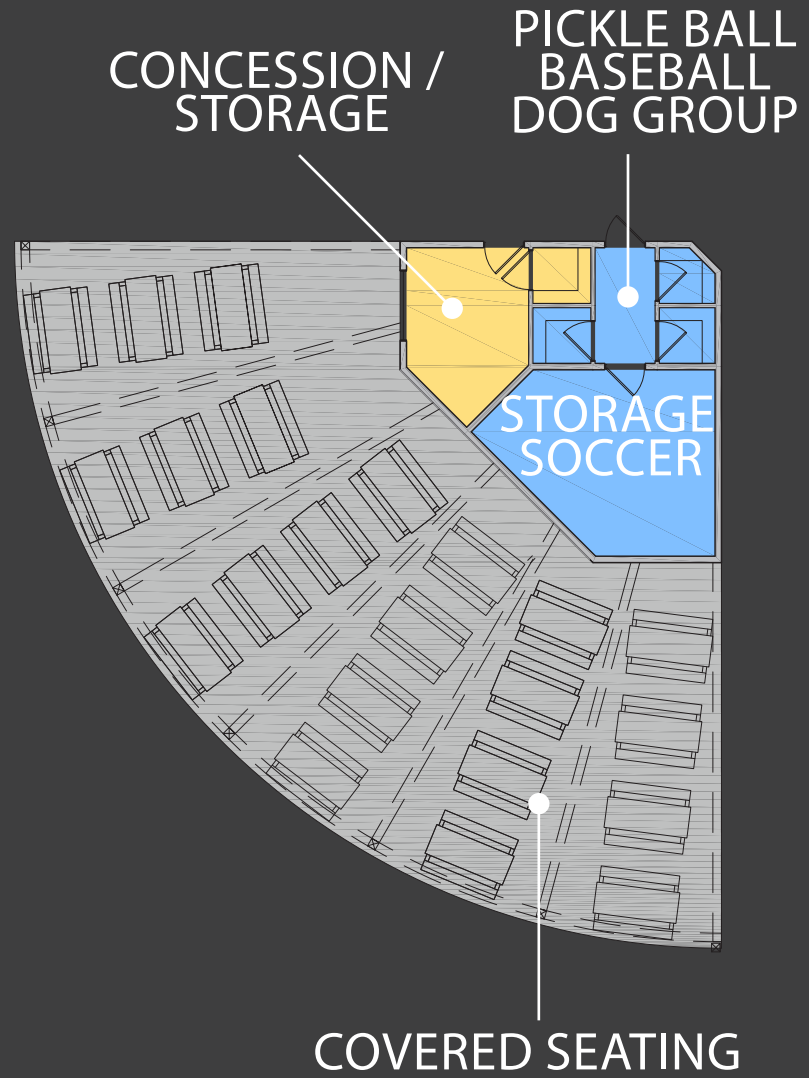

## SITE 3

RENDERING

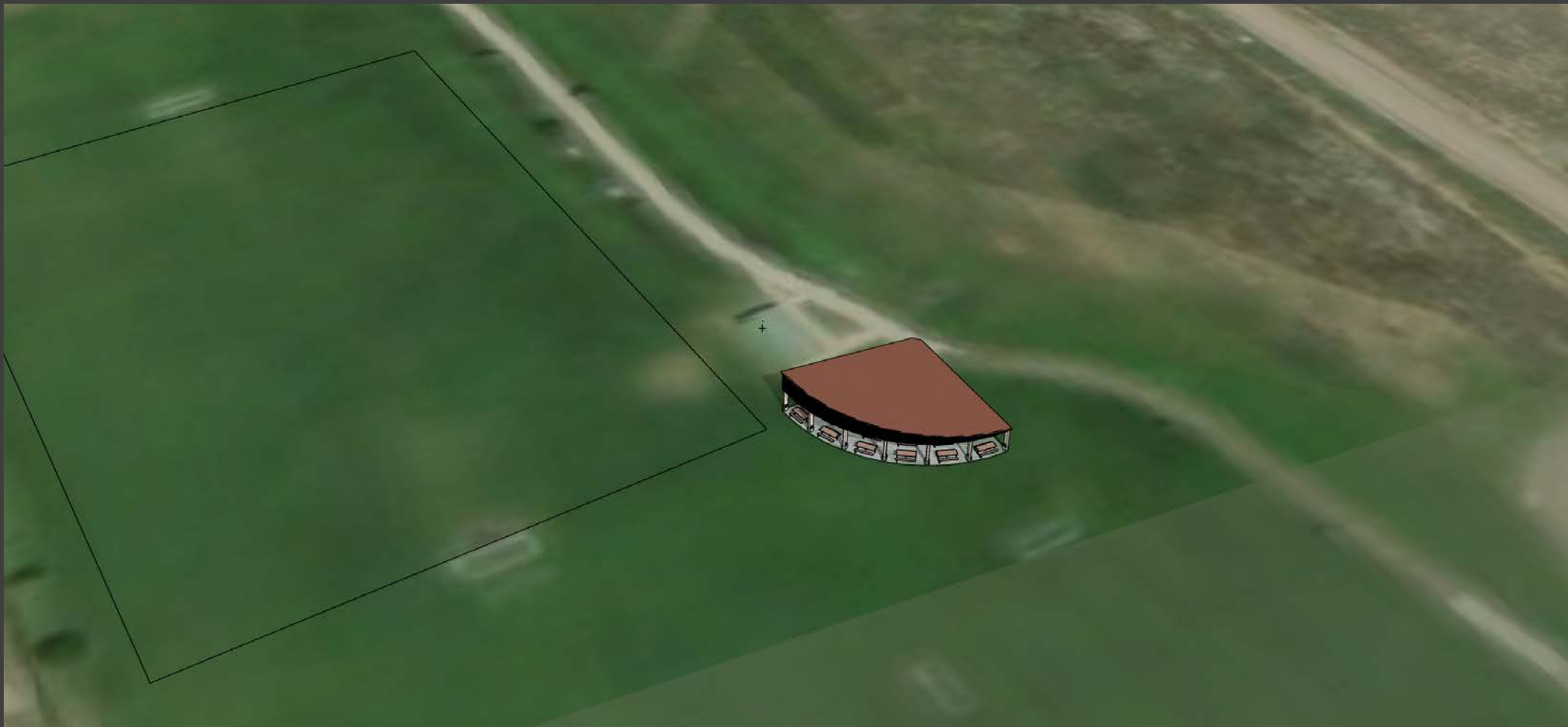

## SITE 3

RENDERING





## SITE 3

RENDERING



# SUMMARY

SITE 1

SITE 2

SITE 3

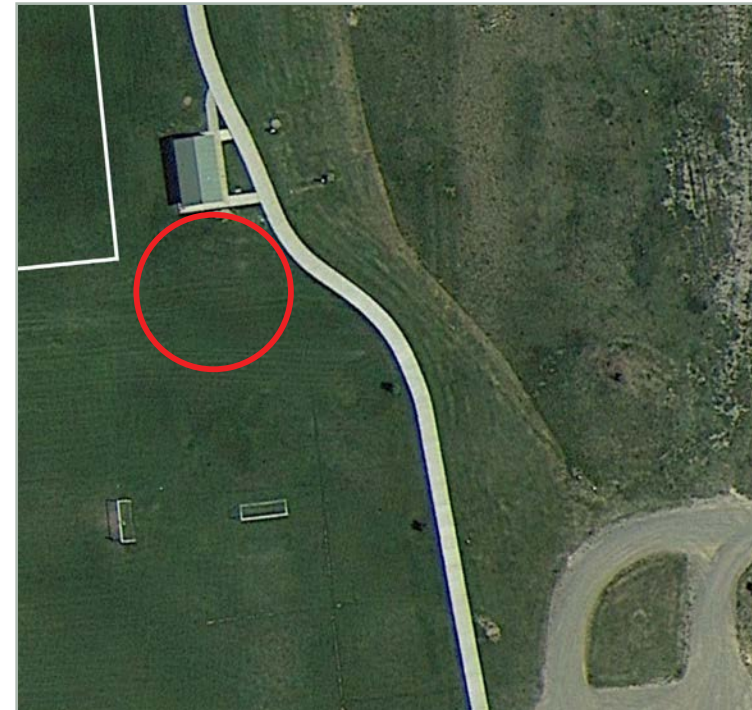
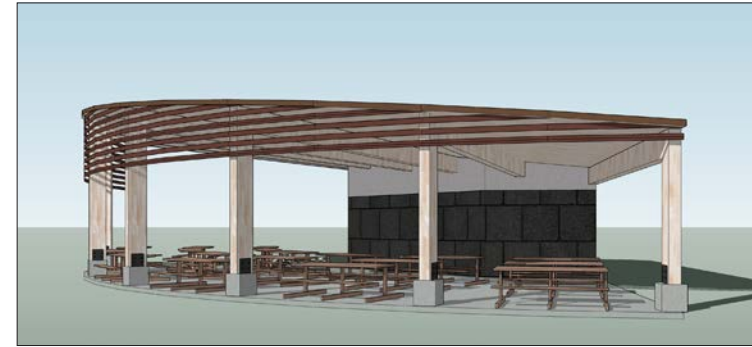
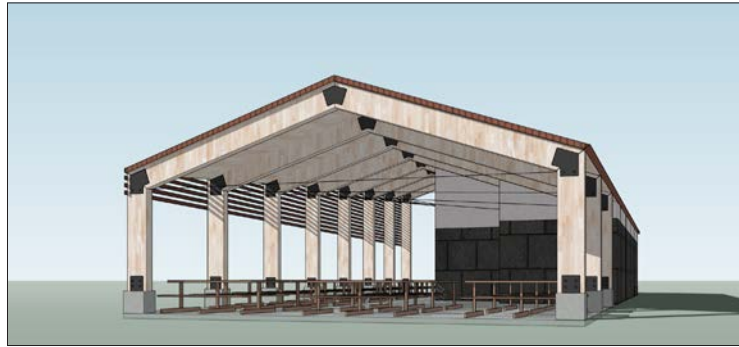
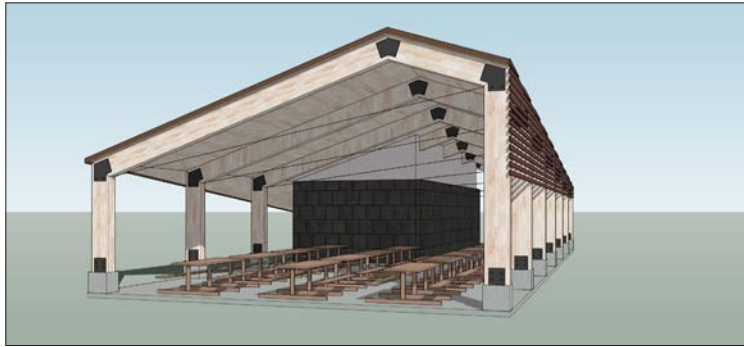



# MATERIAL OPTIONS

RENDERING



SIDING OPTION 1:  
SHINGLED METAL PANELS  
DARK GRAY

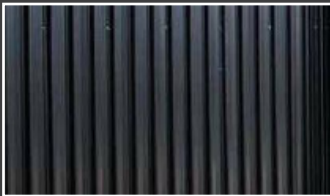

SIDING OPTION 2:  
CORRUGATED METAL  
DARK GRAY COLOR

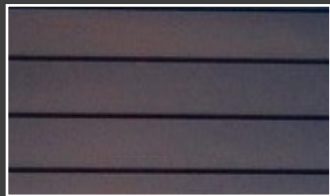

SIDING OPTION 3:  
HORIZONTAL METAL PROFILES  
CHOCOLATE COLOR



SIDING OPTION 4:  
COMPOSITE LAP SIDING  
WARM GRAY

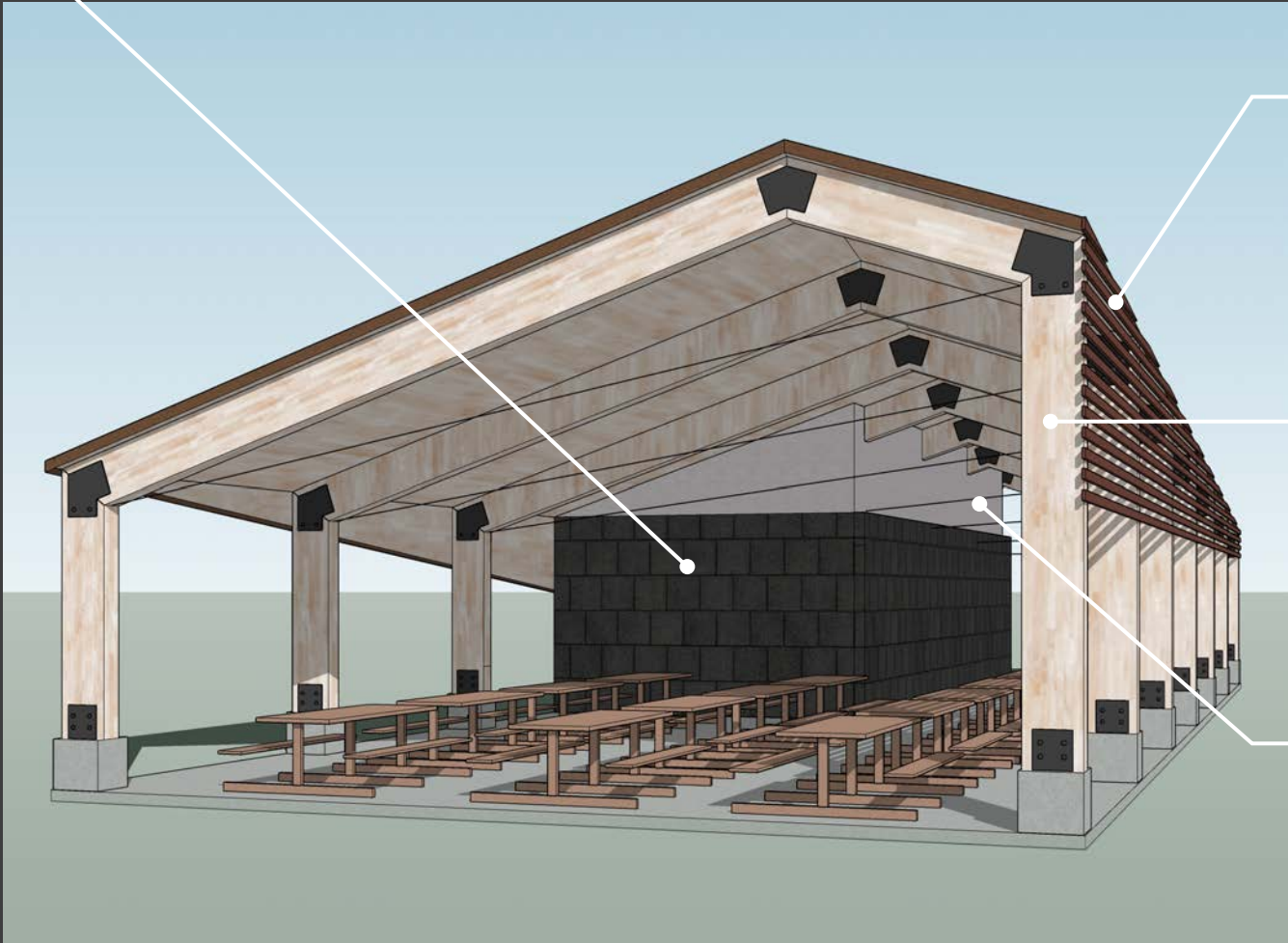

STANDING SEAM METAL ROOF &  
METAL SUN SHADE:  
BRONZE COLOR



CEILING AND BEAMS:  
NATURAL PINE



SIDING MATERIAL ABOVE 8':  
LIGHT GRAY STUCCO



THANK YOU

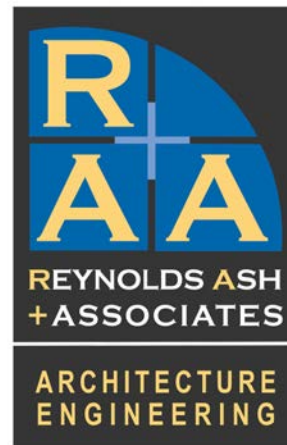

# SCOREBOARD

OPTION 1 - PORTABLE

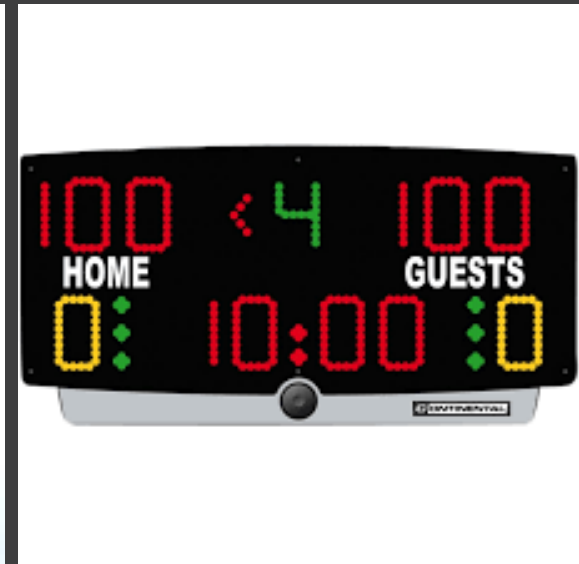

SCOREBOARD

OPTION 2 - INSTALLED





# SCOREBOARD

OPTION 2 - INSTALLED

## LOCATION A - Single sided

### PROS

- Provides flexibility for future field reconfigurations
- Best visibility from new pavilion location

### CONS

- Blocks neighbors views
- Most functional for soccer

## LOCATION B - Double sided

### PROS

- Minimizes impacts to neighbors views
- Could serve baseball as well

### CONS

- Less visible from pavilion location
- More expensive system

