

NOTICE AND CALL OF SPECIAL MEETING OF THE RIDGWAY TOWN COUNCIL

NOTICE IS HEREBY GIVEN that the Ridgway Town Council has called a
Special Meeting to be held on Wednesday, November 20,
2019 commencing at 5:30 p.m. in the Ridgway Community
Center at 201 N. Railroad Street, Ridgway, Colorado.

The purpose of the meeting is:

- 1) Final design direction for the Athletic Park Pavilion



Dated: November 19, 2019

Jen Coates, Town Manager



TOWN OF RIDGWAY
ATHLETIC PARK PAVILION
CONCEPT DESIGN OPTIONS
NOVEMBER 14, 2019

WWW.RA-AE.COM

DESIGN TEAM





SITE







PROGRAM

STAKEHOLDER INTERVIEWS

PROGRAM

Baseball

Soccer

Planning Commissioner

RAT Group

Dog Owners

Pickle-ball

Polo Estates Development

Planning Department

STAKEHOLDER MEETING INTERVIEW QUESTIONS

PROGRAM

Current Park Use

How does your group currently use the park?

How often & what times does your group currently use the park?

Pavilion Use

How do you envision your group using the Pavilion?

How often do you envision your group using the Pavilion?

Pavilion Size

What size /type of storage does your group require?

How much sheltered seating does your group require?

What size / function of the concessions are is critical for your group?

Features

Are there any other design features or considerations that would make the pavilion more functional for your group?

Style

What building in town best captures the character of Ridgway?

What building in town best captures the history and future of Ridgway?

What materials or style do you envision for the pavilion?

Location

What Pavilion location would be best for the use of your group?

DESIGN OBJECTIVES

PROGRAM

Environment

- Design to be sensitive to prevailing winds
- Design to consider sun angles and optimizing shade
- Design should capture mountain views

Context

- Design to be low in height so views are not obstructed
- Design to reference local materials and styles

Location

- Locate in a way that takes advantage of existing utilities
- Locate to best serve the park functions
- Location to be sensitive to future park master planning

SQUARE FOOTAGE REQUESTS

PROGRAM

Storage

- 200 SF Soccer Storage
- 16 SF Pickle-ball (snowblower)
- 16 SF Dog Owner's Group (training / agility)
- ? SF Baseball
- 0 SF Public works
- 0 SF RAT group

Provided

200 SF
25 SF
25 SF
25 SF

Concessions

- 2 Person concessions
- Concessions storage
- Service counter with roll up door
- 2 bay sink
- Counter-tops
- Power

100 SF
25 SF

Shelter

- 40-200 people
- Power - lockable
- Covered Seating : Picnic Tables

1,900 SF (120 People)

Total

2,300 SF

ADDITIONAL REQUESTS

PROGRAM

- Bleachers
- Refrigerator
- Operable enclosure (glass, shades, curtains)
- Play structure
- Mural
- Kick wall
- Bottle Filler
- Dog water fountain
- Field lighting
- Restroom facade improvements
- Fireplace on timer
- Solar Panels
- Scoreboard
- WIFI
- Changing room – pickle ball
- Coaches office – soccer
- Locker room – soccer
- Ditch / drainage improvement

LOCATION OPTIONS

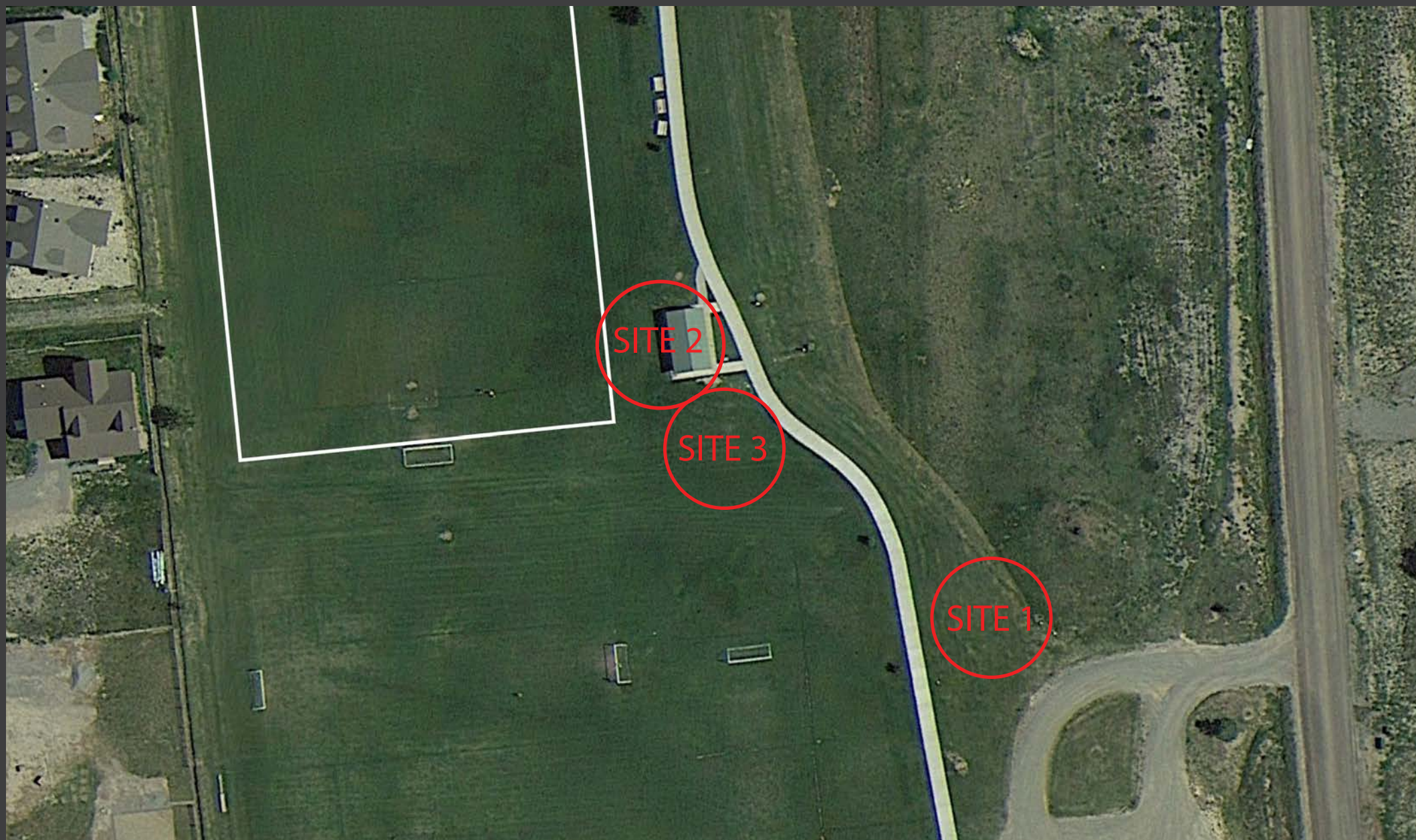

SITE 1

LOCATION OPTION

PROS

- Closest to the parking area
- Closer to future phases of the park
- Highly visible from the road
- Standalone location not impacted by restrooms

CONS

- Furthest from utilities
- Furthest from the restrooms
- Furthest from soccer fields



SITE 1

PLAN

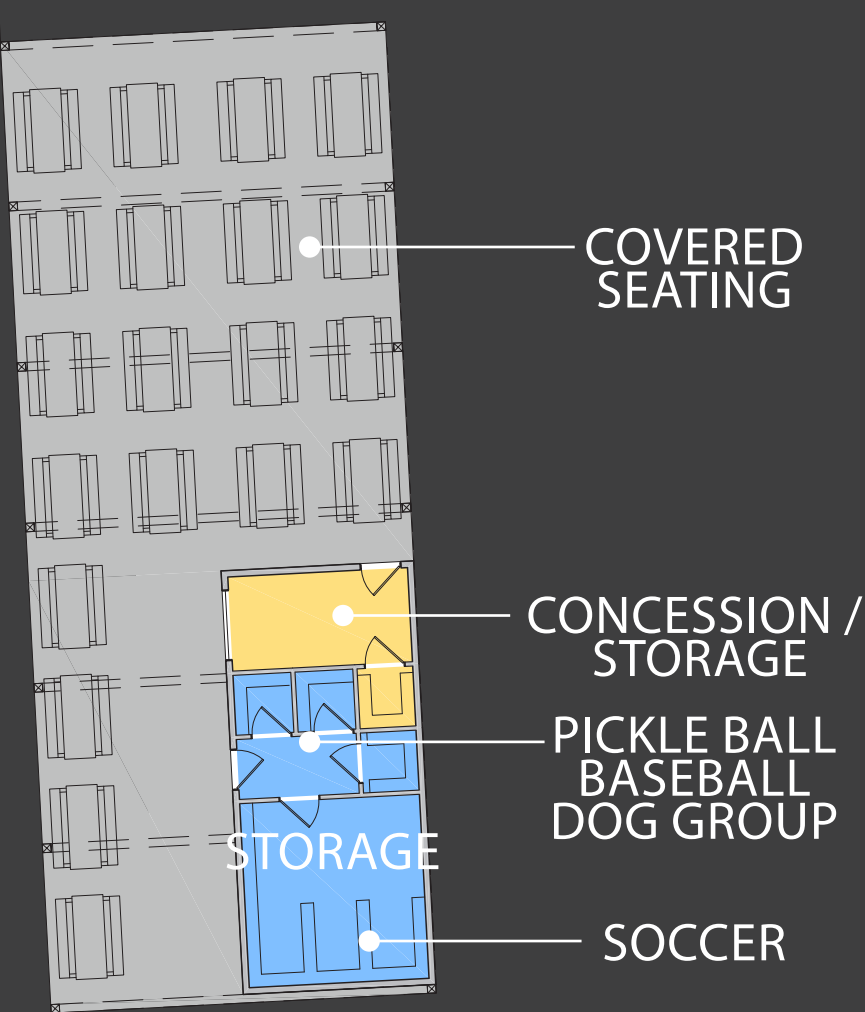

SITE 1

RENDERING



SITE 1

RENDERING

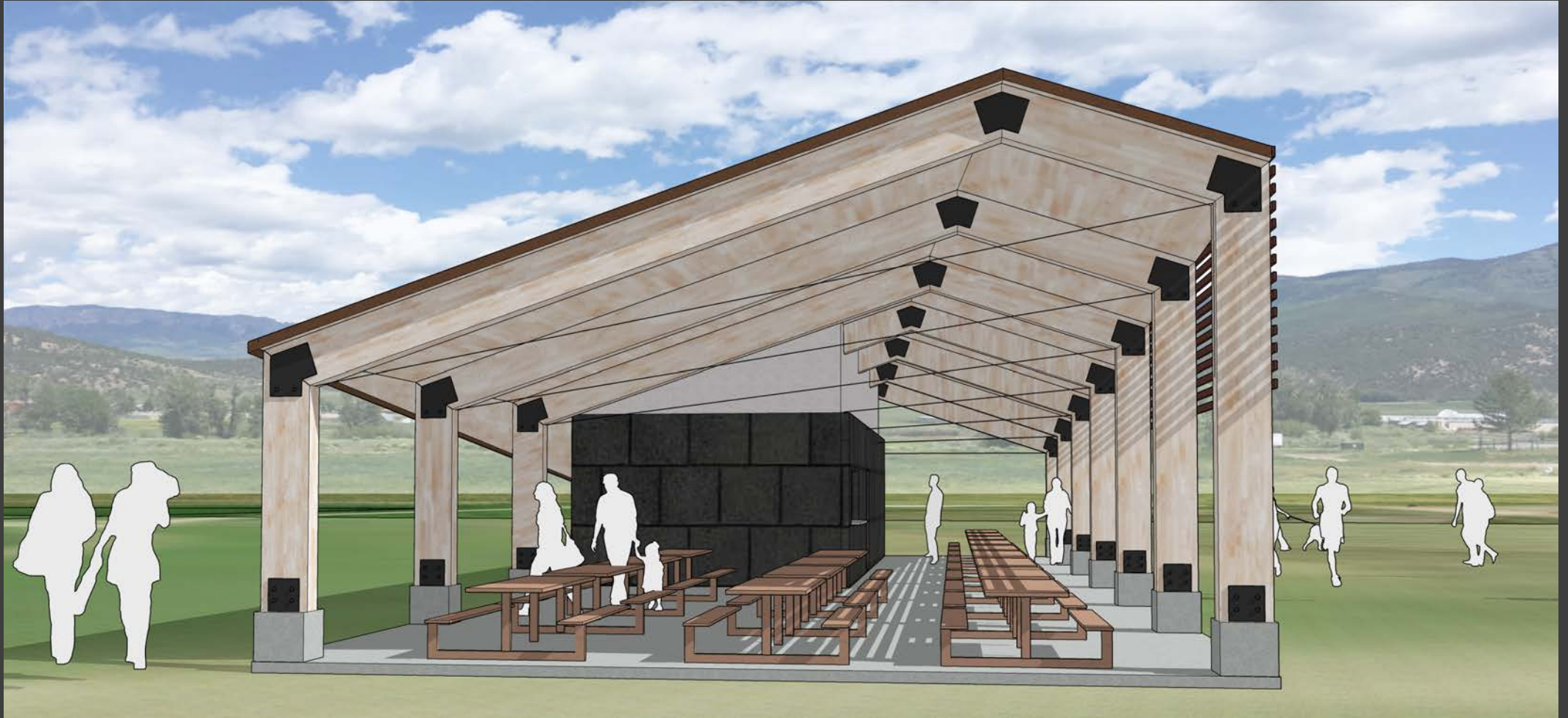

SITE 1

RENDERING



SITE 2

LOCATION OPTION

PROS

- Incorporates / disguises restrooms
- Consolidates resources
- Closest to utilities
- Closest to soccer fields

CONS

- Furthest from the parking area
- Least identifiable from road

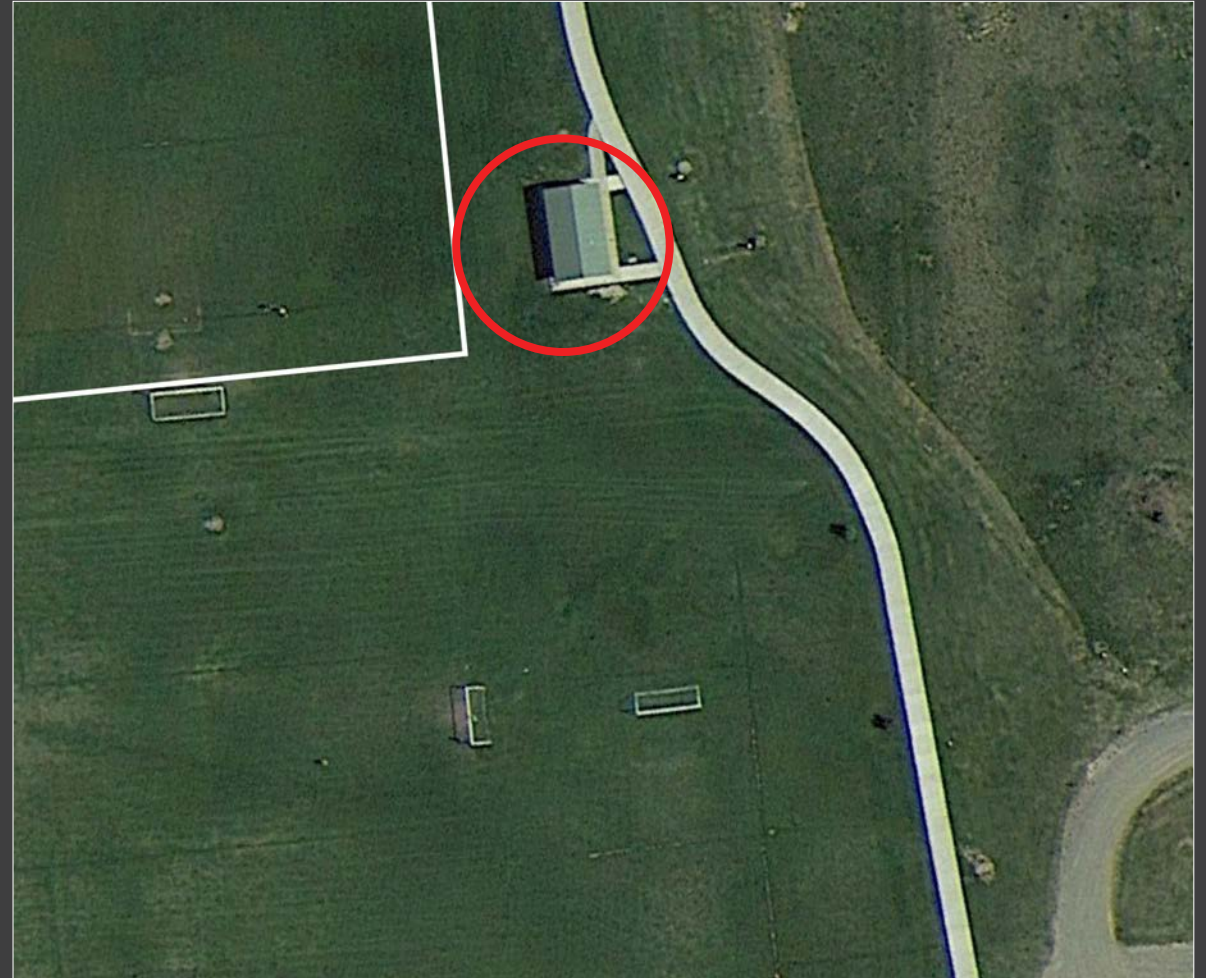

SITE 2

PLAN

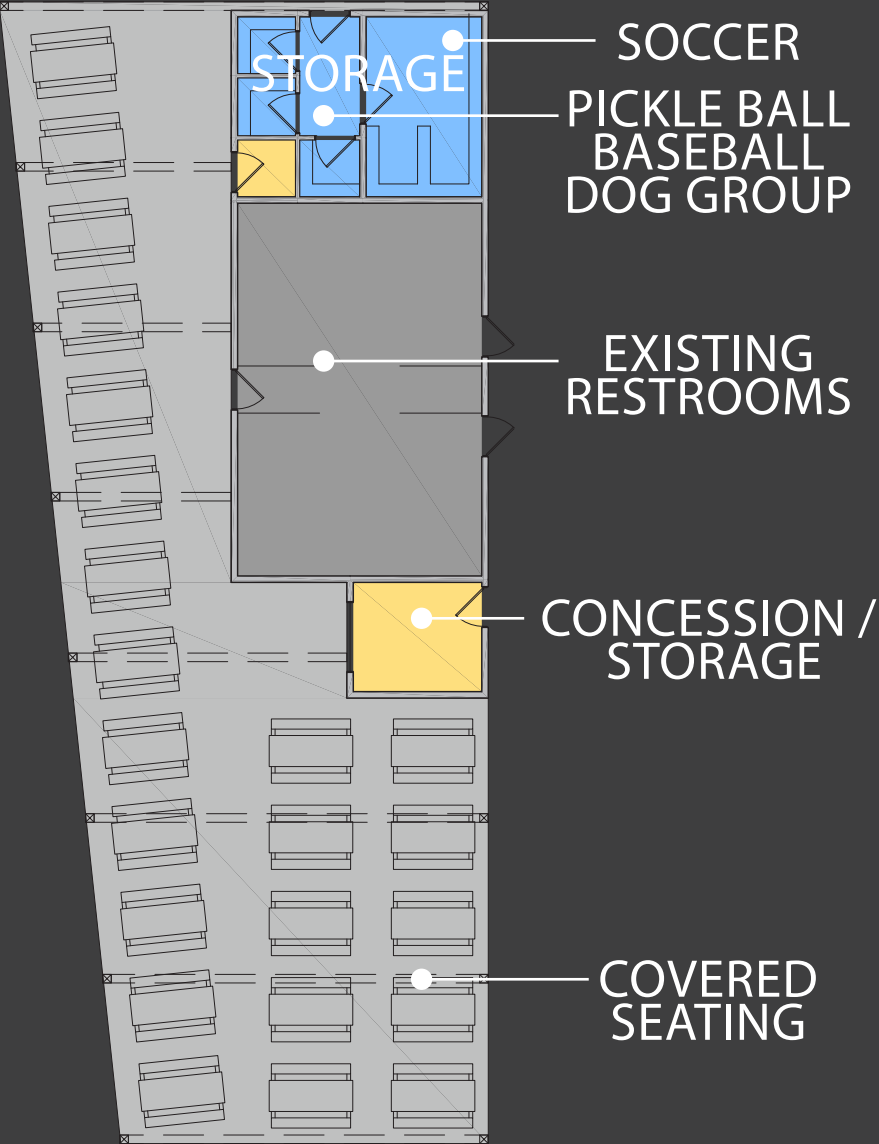

SITE 2

RENDERING



SITE 2

RENDERING



SITE 2

RENDERING



SITE 2

RENDERING



SITE 3

LOCATION OPTION

PROS

- Adjacent to restrooms
- Close to utilities
- Close to soccer fields

CONS

- Furthest from the parking area



SITE 3

PLAN

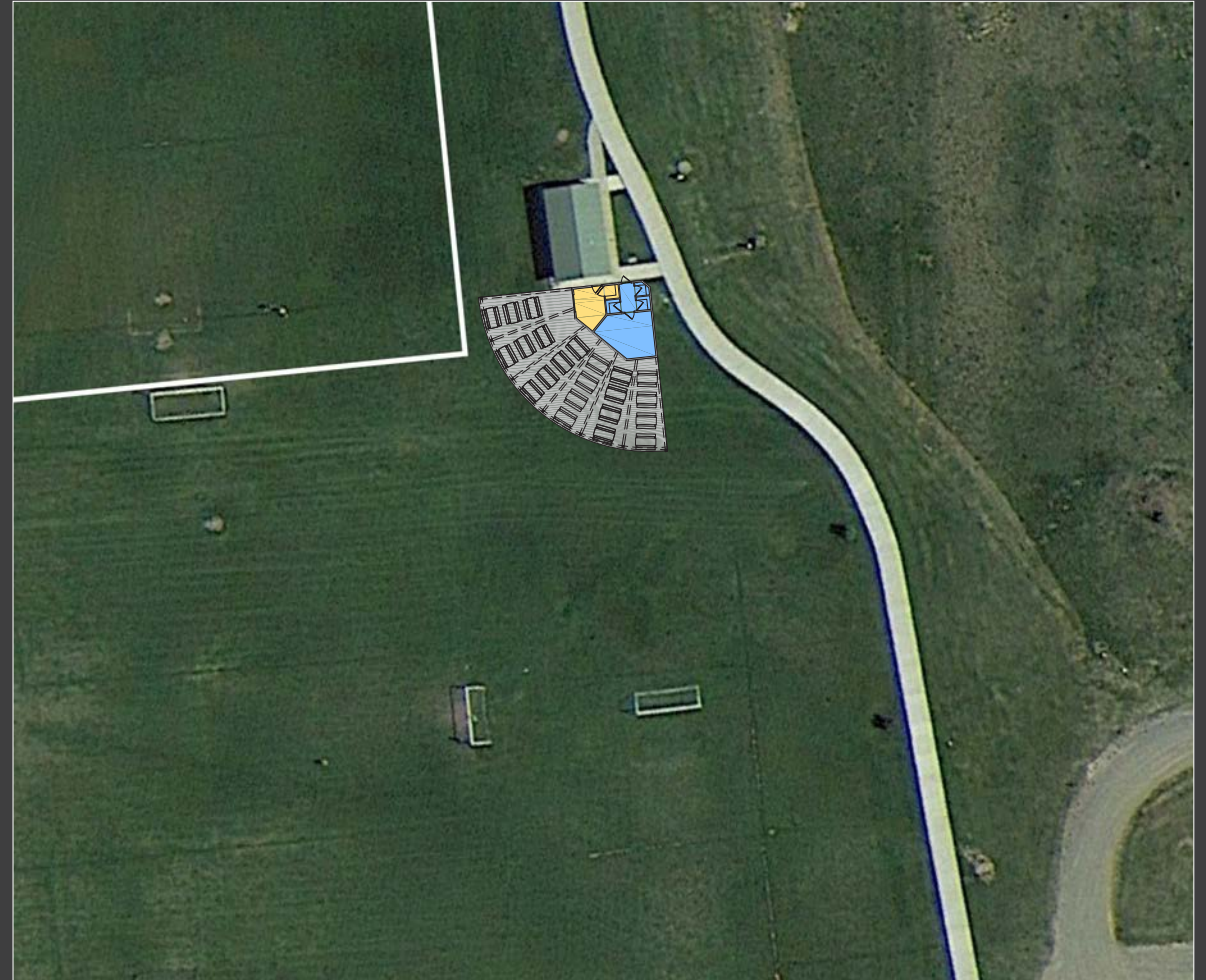
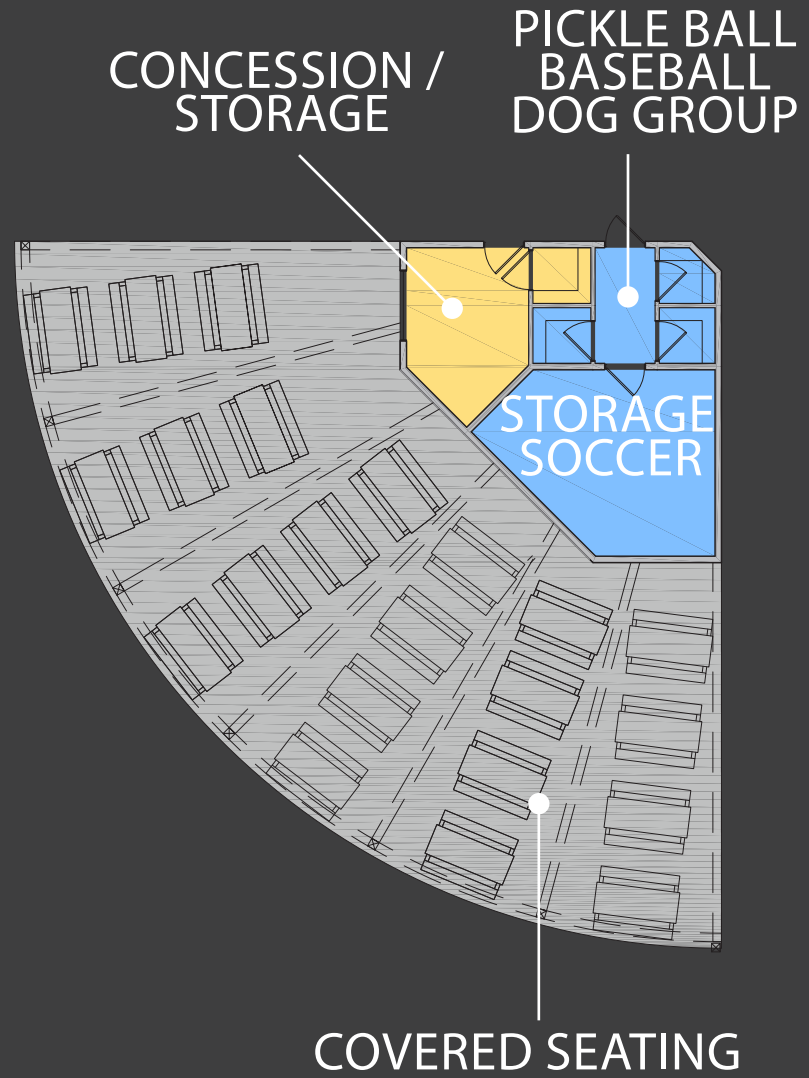

SITE 3

RENDERING

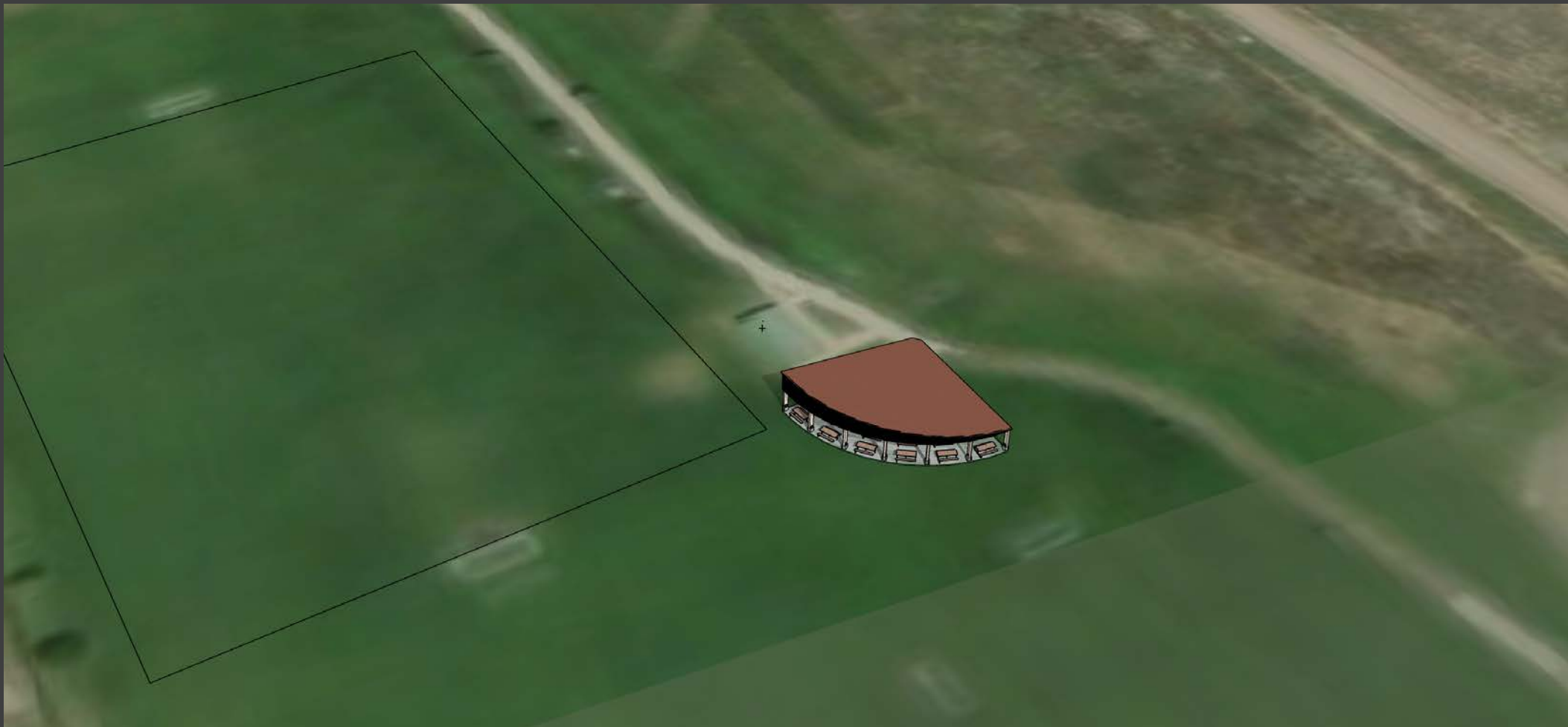

SITE 3

RENDERING



SITE 3

RENDERING



SUMMARY

SITE 1

SITE 2

SITE 3

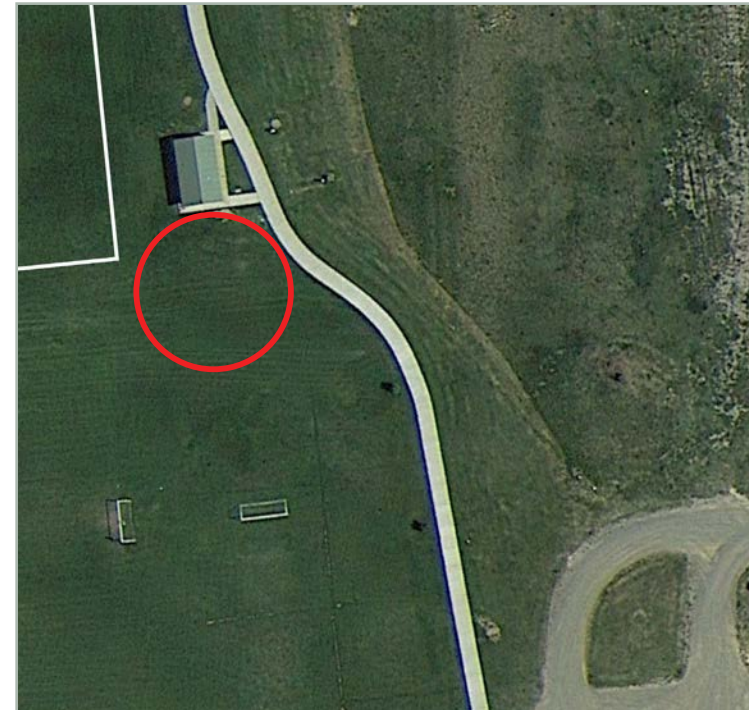
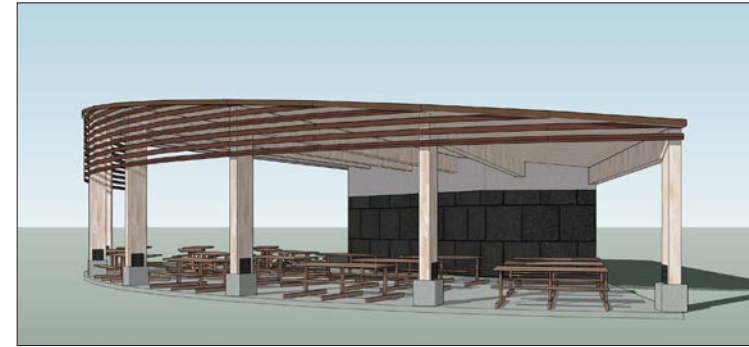
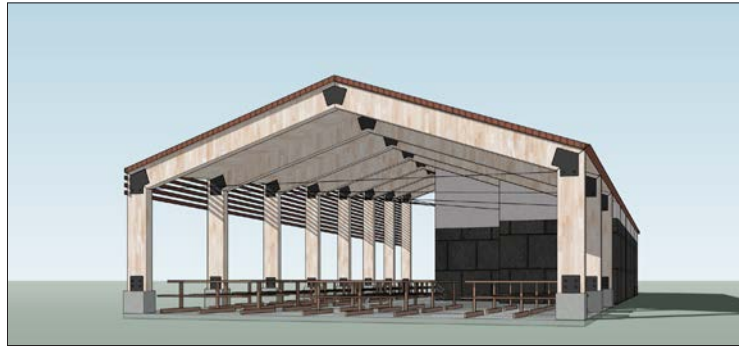
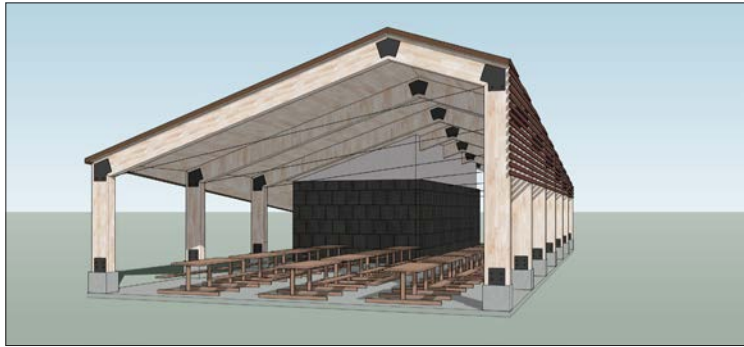

MATERIAL OPTIONS

RENDERING



SIDING OPTION 1:
SHINGLED METAL PANELS
DARK GRAY

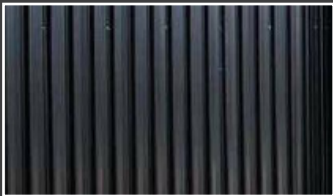

SIDING OPTION 2:
CORRUGATED METAL
DARK GRAY COLOR

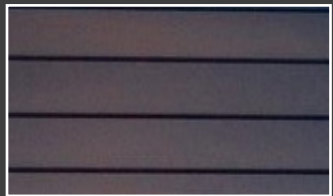

SIDING OPTION 3:
HORIZONTAL METAL PROFILES
CHOCOLATE COLOR



SIDING OPTION 4:
COMPOSITE LAP SIDING
WARM GRAY

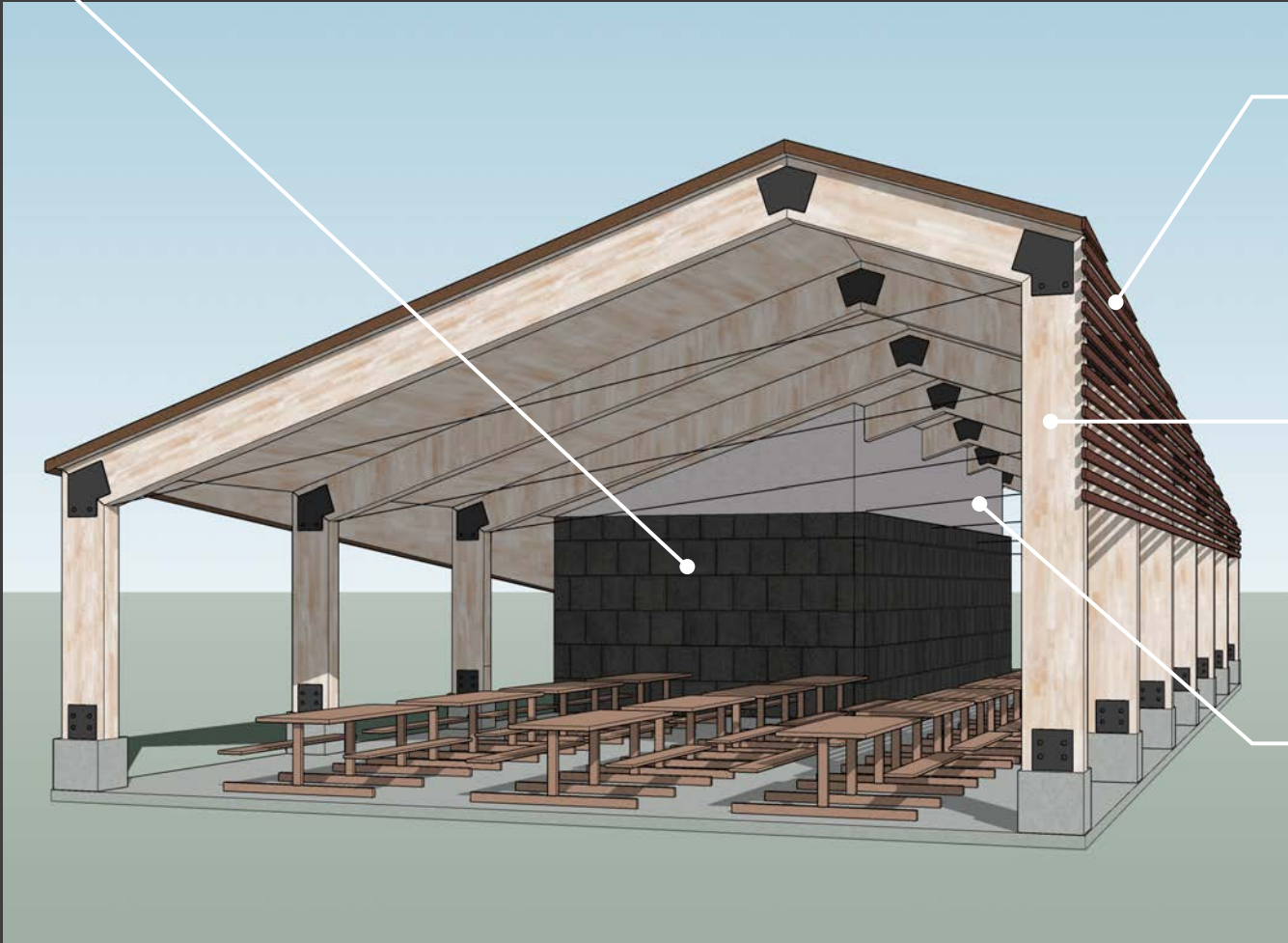

STANDING SEAM METAL ROOF &
METAL SUN SHADE:
BRONZE COLOR



CEILING AND BEAMS:
NATURAL PINE



SIDING MATERIAL ABOVE 8':
LIGHT GRAY STUCCO

THANK YOU



SCOREBOARD

OPTION 1 - PORTABLE

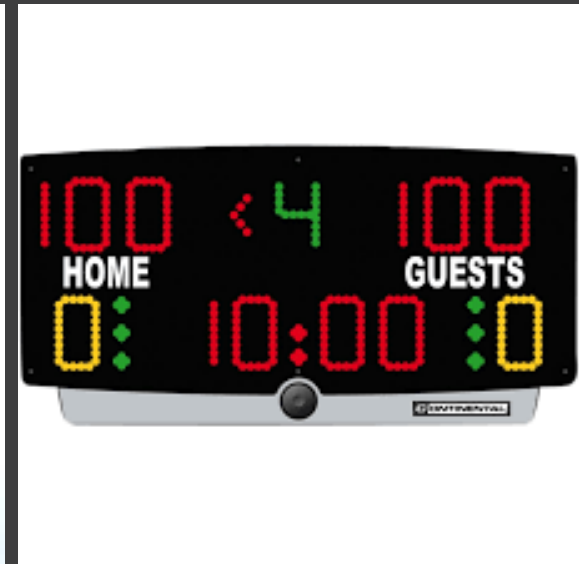

SCOREBOARD

OPTION 2 - INSTALLED



SCOREBOARD

OPTION 2 - INSTALLED

LOCATION A - Single sided

PROS

- Provides flexibility for future field reconfigurations
- Best visibility from new pavilion location

CONS

- Blocks neighbors views
- Most functional for soccer

LOCATION B - Double sided

PROS

- Minimizes impacts to neighbors views
- Could serve baseball as well

CONS

- Less visible from pavilion location
- More expensive system





Durango
1140 Main Avenue, Suite B
Durango, Colorado 81301
P – 970.259.7494
F – 970.259.7492

Pagosa Springs
262 Pagosa St. Suite 200
Pagosa Springs, CO 81147
P – 970.264.6884
F – 970.264.0997

Presentation Minutes:

Project Name	Ridgway Pavilion - 19175
Subject	Conceptual Presentation Minutes
Date	November 19, 2019
Item No.	
1.0	Location Location 3 was unanimously preferred <ul style="list-style-type: none">- Furthest away from traffic near parking lot (X Option 1)- Does not impede play of game (x Option 2)- Maximizes views and relationships to other fields- Location 3 should be adjusted to maintain 10' clear from field- Location 3 should be adjusted to create space between the restroom
2.0	Design Design 3 was unanimously preferred because <ul style="list-style-type: none">- Creates sweeping views of mountains- Most dynamic and interesting form- Different / unique from surroundings- "Graceful"
4.0	Materials Modern Rustic <ul style="list-style-type: none">- Lighter color material needed to clad the building- Mural was well received, should be positioned on east wall- Darker stain to be considered for wood
5.0	Program Space program (square feet for users) was accepted with minor changes <ul style="list-style-type: none">- General / shared storage space needed- Additional stakeholders identified lacrosse, skate park.- 50 SF needed for baseball- Lacrosse goal storage needed (exterior space and surface to lock to)
6.0	Additional Requests Requests currently included <ul style="list-style-type: none">- Mural- Restroom façade improvements Requests were prioritized as follows <ul style="list-style-type: none">- Lightning shelter- Counter at edges of pavilion- Year round bathroom access- Mop sink for concessions- Kick wall- Bleachers- WIFI- Pathway lighting- Solar Panels- Focal point for wedding ceremony Additional requests to be considered for future phases



Durango

1140 Main Avenue, Suite B
Durango, Colorado 81301
P – 970.259.7494
F – 970.259.7492

Pagosa Springs

262 Pagosa St. Suite 200
Pagosa Springs, CO 81147
P – 970.264.6884
F – 970.264.0997

- Play structure
- Ditch / drainage upgrades
- Refrigerator
- Operable enclosure (glass, shades, curtains)
- Field lighting
- Scoreboard

7.0

Budget

Building as presented is on budget

- Detailed budget for option 3 to be prepared
- Additional requests to be included / prioritized based on remaining budget
- Current budget includes funds to clad exiting bathroom building

8.0

Next Steps

- Incorporate program updates
- Prepare budget
- Refine exterior materials

9.0

Attendee comments attached



Durango
1140 Main Avenue, Suite B
Durango, Colorado 81301
P – 970.259.7494
F – 970.259.7492

Pagosa Springs
262 Pagosa St. Suite 200
Pagosa Springs, CO 81147
P – 970.264.6884
F – 970.264.0997

Project Name 19175 Ridgway Park Pavilion

Meeting Concept Option Presentation

Date November 13, 2019

Location Town Offices

Attendee Name:

Site



Comments NO BLACK WALL - WOOD INSTEAD

Option 1

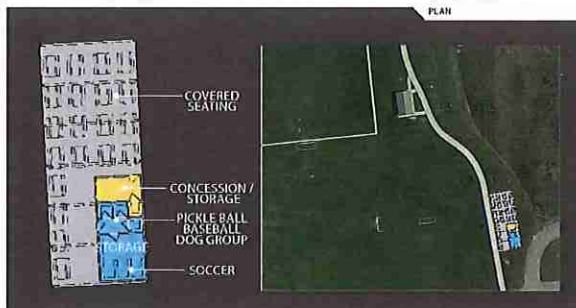

Comments

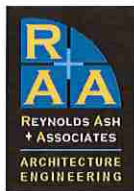

Durango
1140 Main Avenue, Suite B
Durango, Colorado 81301
P – 970.259.7494
F – 970.259.7492

Pagosa Springs
262 Pagosa St. Suite 200
Pagosa Springs, CO 81147
P – 970.264.6884
F – 970.264.0997

Option 2

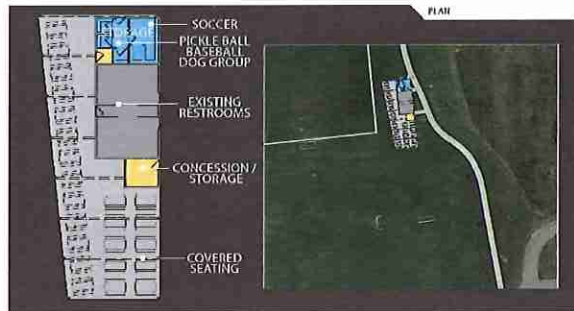

Comments

Option 3



Comments

LIKE THIS AND SITE DESIGN

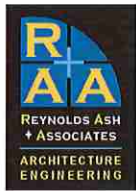

Durango
1140 Main Avenue, Suite B
Durango, Colorado 81301
P – 970.259.7494
F – 970.259.7492

Pagosa Springs
262 Pagosa St. Suite 200
Pagosa Springs, CO 81147
P – 970.264.6884
F – 970.264.0997

Project Name 19175 Ridgway Park Pavilion

Meeting Concept Option Presentation

Date November 13, 2019

Location Town Offices

Attendee Name:

Site



Comments

Option 1

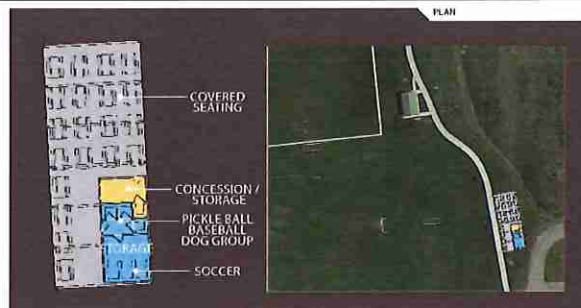

Comments



Durango
1140 Main Avenue, Suite B
Durango, Colorado 81301
P - 970.259.7494
F - 970.259.7492

Pagosa Springs
262 Pagosa St. Suite 200
Pagosa Springs, CO 81147
P - 970.264.6884
F - 970.264.0997

Option 2

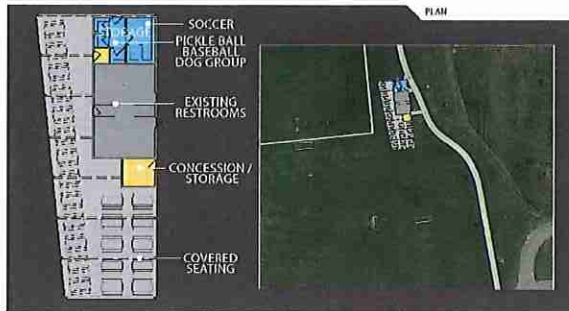

Comments

Option 3



Comments

NEEDING RECEPTION

- MINIMIZER LIGHTING
- LANDSCAPING BUDGET PRIORITY. TREES!
- GREATEST BUILDING DESIGN: MODERN, LOCALLY INSPIRED FORMS, RUBBED MATERIALS: IMPORTANT.
- NEED OCCUPANCY ARCHITECTURE: EVERY WALL WILL BE, A KICK WALL, EVERY COR. BASIC & SKATEBOARD FEATURE.
- SITE 1 w/ PAVED DRIVING SURFACE NEARBY LIKELY BEST.
- GAVE GREAT WORK ON BUILDING DESIGN!
- CANNOT BUILD THIS W/O HORIZONTAL (BASIC) DESIGN OF PARK.

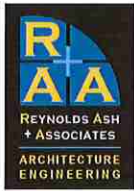

Durango
1140 Main Avenue, Suite B
Durango, Colorado 81301
P – 970.259.7494
F – 970.259.7492

Pagosa Springs
262 Pagosa St. Suite 200
Pagosa Springs, CO 81147
P – 970.264.6884
F – 970.264.0997

Project Name 19175 Ridgway Park Pavilion

Meeting Concept Option Presentation

Date November 13, 2019

Location Town Offices

Attendee Name:

Site



Comments

Option 1



Comments

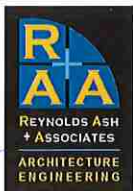

Durango
1140 Main Avenue, Suite B
Durango, Colorado 81301
P - 970.259.7494
F - 970.259.7492

Pagosa Springs
262 Pagosa St. Suite 200
Pagosa Springs, CO 81147
P - 970.264.6884
F - 970.264.0997

Option 2

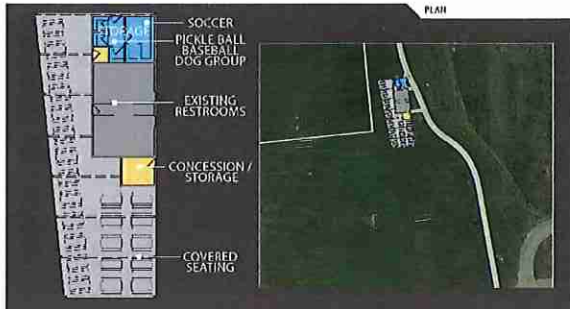

Comments

Option 3



Comments

prefer this option - best Feng Shui; can we include facade improvements on the restroom or do the mural on the restroom. Low maintenance materials please; do not want stucco (we have wood pecker issues)
could RA+A provide or recommend some programming rules/protocol for town + users?
this location doesn't seem to impede on future uses (regulation ^{soccer} field, playground, etc)
please ensure ADA compliant; we hope to have middle mile fiber to the park next year;
include lighting of pavilion

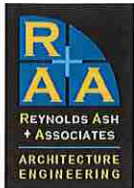

Durango
1140 Main Avenue, Suite B
Durango, Colorado 81301
P – 970.259.7494
F – 970.259.7492

Pagosa Springs
262 Pagosa St. Suite 200
Pagosa Springs, CO 81147
P – 970.264.6884
F – 970.264.0997

Project Name 19175 Ridgway Park Pavilion

Meeting Concept Option Presentation

Date November 13, 2019

Location Town Offices

Attendee Name: *Russ Meyer*

Site



Comments

Option 1

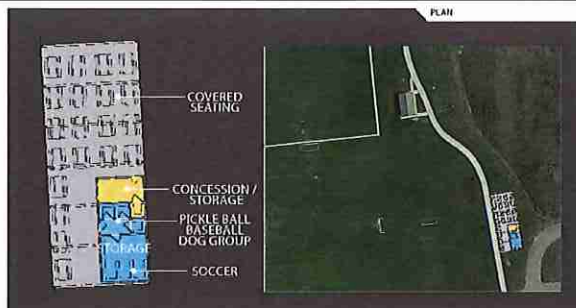

Comments

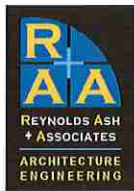

Durango
1140 Main Avenue, Suite B
Durango, Colorado 81301
P – 970.259.7494
F – 970.259.7492

Pagosa Springs
262 Pagosa St. Suite 200
Pagosa Springs, CO 81147
P – 970.264.6884
F – 970.264.0997

Option 2

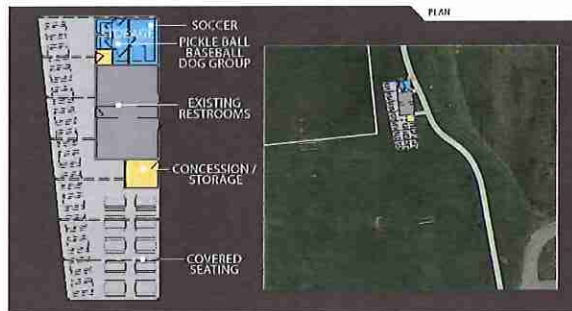

Comments

Option 3



Comments Like option 3 best. Adds if money available: bike racks, dress up exterior walls of restrooms. Have some concerns with materials. All seems too new and contemporary. Could be done with design that was a bit more rustic (wood beams, maybe).

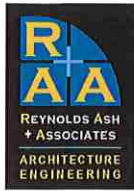

Durango
1140 Main Avenue, Suite B
Durango, Colorado 81301
P – 970.259.7494
F – 970.259.7492

Pagosa Springs
262 Pagosa St. Suite 200
Pagosa Springs, CO 81147
P – 970.264.6884
F – 970.264.0997

Project Name 19175 Ridgway Park Pavilion

Meeting Concept Option Presentation

Date November 13, 2019

Location Town Offices

Attendee Name: *Robyn Cascade*

Site



Comments *Prefer site 1 for its proximity to parking and lessens impact on green space but is close enough to existing restrooms.*

Option 1

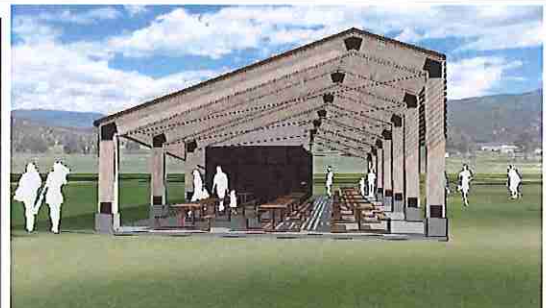
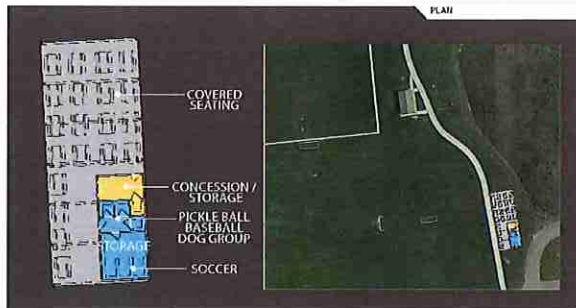

Comments *The covered shelter in site 1 close to parking accommodates people with limited mobility. It also doesn't impact future recreation development within athletic space.*

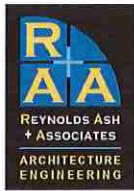

Durango
1140 Main Avenue, Suite B
Durango, Colorado 81301
P – 970.259.7494
F – 970.259.7492

Pagosa Springs
262 Pagosa St. Suite 200
Pagosa Springs, CO 81147
P – 970.264.6884
F – 970.264.0997

Option 2

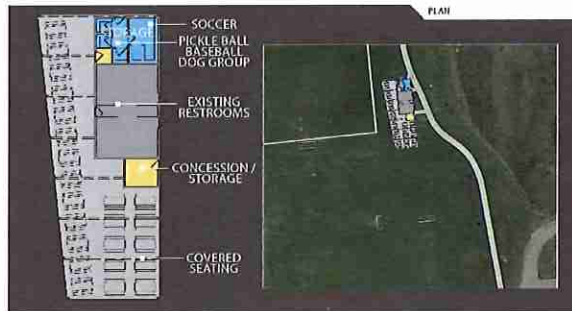

Comments

Option 3

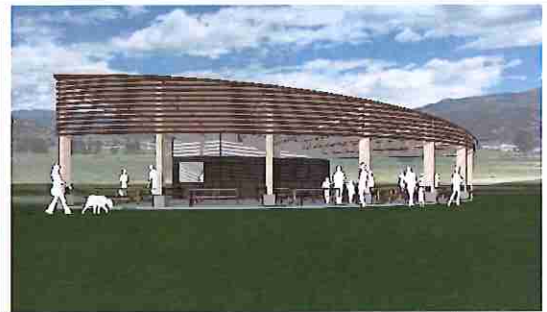

Comments *though I like the non rectangular shape, it's rather odd @ this site.*



Durango

1140 Main Avenue, Suite B
Durango, Colorado 81301
P – 970.259.7494
F – 970.259.7492

Pagosa Springs

262 Pagosa St. Suite 200
Pagosa Springs, CO 81147
P – 970.264.6884
F – 970.264.0997

Project Name 19175 Ridgway Park Pavilion

Meeting Concept Option Presentation

Date November 13, 2019

Location Town Offices

Attendee Name:

Site



Comments

Option 1

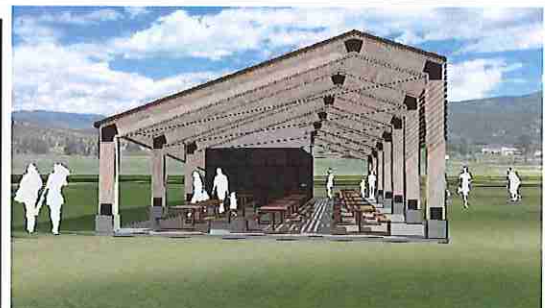
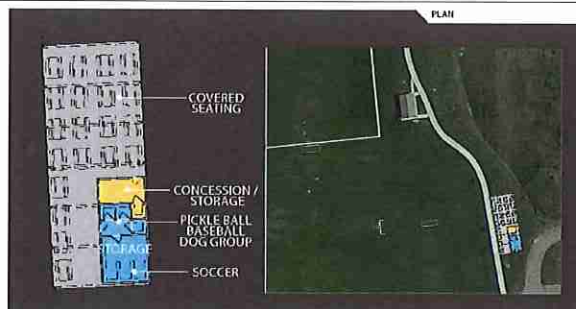

Comments

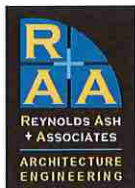

Durango
1140 Main Avenue, Suite B
Durango, Colorado 81301
P – 970.259.7494
F – 970.259.7492

Pagosa Springs
262 Pagosa St. Suite 200
Pagosa Springs, CO 81147
P – 970.264.6884
F – 970.264.0997

Option 2

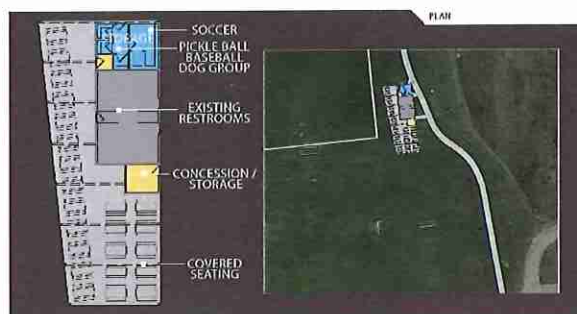

Comments

Option 3



Comments

yes - This one